

Control Valve, Fuel Evaporator, Replace

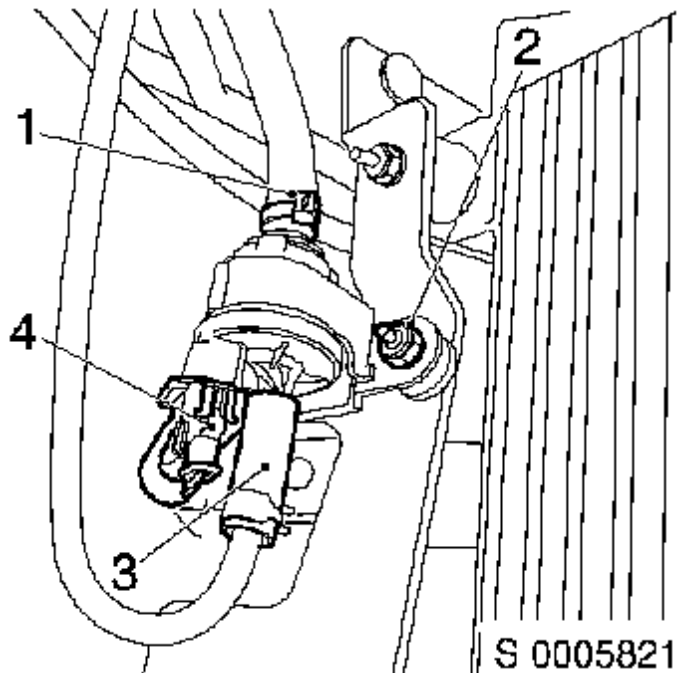

Remove

1. Raise vehicle to suitable working height
2. Remove rear road wheel from right side
 - Remove security bolt
 - Use special socket located under front bonnet
 - Remove 4x wheel bolt
3. Remove right rear wheel arch liner
 - Remove 4x screw, 2x clip
4. Remove control valve for fuel evaporator
 - Disconnect engine harness connector
 - Release integral clip (4)
 - Release fuel evaporator canister from control valve
 - Remove, then discard cable tie (1)
 - Disconnect vacuum pipe (3) from control valve
 - Pull off
5. Remove control valve from chassis support bracket
 - Remove, then discard 2x nut (2)
 - Remove 2x washer



Install

6. Install control valve to chassis support bracket
 - Install 2x washer
 - Install 2x new nut
7. Connect vacuum pipe to control valve
 - Push fit
8. Connect fuel evaporator canister hose to control valve
 - Install new cable tie
9. Connect engine harness connector to control valve
 - Secure integral clip
10. Install right rear wheel arch liner
 - Install 4x screw, 2x clip
11. Install rear wheel to right side
 - Install 4x bolt, security bolt
 - Do not tighten
12. Remove vehicle support

13. Lower vehicle
14. Secure rear road wheel
 - Tighten 4x bolt, security bolt **90 Nm**